

CARTELLE RICAVATE DA LAMIERA STAMPATA CON 3 RIGHE DI TENUTA

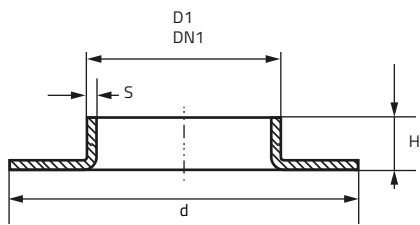

D1	DN 1	POLLICI GAS	d mm	H mm	S mm
21,3	15	1/2"	43	7	2 3
26,9	20	3/4"	58	8	2 3
33,7	25	1"	68	9	2 3
42,4	32	1"1/4	78	10	2 3
48,3	40	1"1/2	88	10	2 3
60,3	50	2"	102	12	2 3
70			122	12	2
76,1	65	2"1/2	122	12	2 3
80			122	13	2
84			138	13	2
88,9	80	3"	139	12	2 3
101,6	90	3"1/2	158	14	2 3

CARTELLE RICAVATE DA LAMIERA STAMPATA CON 3 RIGHE DI TENUTA

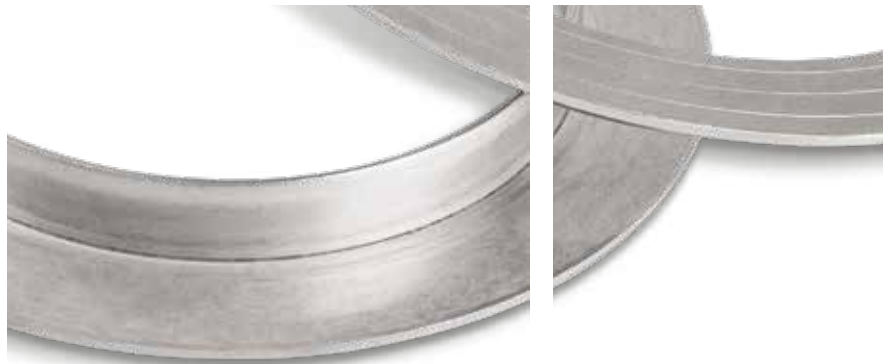
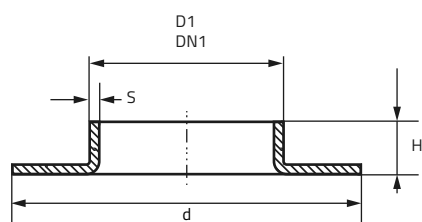

D1	DN 1	POLLICI GAS	d mm	H mm	S mm
104			148	16	2
114,3	100	4"		16	2 3
129			188	14	2 3
139,7	125	5"	184	16	2 3
154			212	13	2 3
168,3	150	6"	212	17	2 3
204			268	17	2
219,1	200	8"	270	18	2 3
254			320	15	2
273	250	10"	323	18	2 3
323	300	12"	370	17	2 3
355	350	14"	430	20	3
406	400	16"	482	15	3
508	500	20"	585	17	3